



COMPLYING WITH DIRECTIVE

UNI EN 14891

DM 01 P

LQUID-APPLIED WATERPROOFING
PRODUCTS FOR USE BENEATH
CERAMIC TILING BONDED WITH
ADHESIVES

DESCRIPTION OF THE PRODUCT

Bitumen Waterproofing Adhesion promoter based on high quality polymers and selected charges in aqueous dispersion. Such elements convey to the product an exceptional Crack-Bridging resistance and a very high waterproofing power.

APPLICABLE REGULATIONS

WINGRIP® BITUMINOSO meets the following requirements:

- **UNI EN 14891:** Liquid applied waterproofing products to be used under ceramic tiles, that have been installed with cement-based tile adhesives.
- **ANSI A 118.10:** US national specifications for waterproofing membranes for the overlaying of ceramic and stone tiling.
- **ANSI A 118.12:** US national specifications for membranes suitable for insulating cracks, for the overlaying of ceramic and stone tiling.
- **EC1 PLUS** labeling, which identifies EMICODE certified products: construction products with very low volatile organic compound (VOC) and semi-volatile organic compound emissions.

CHARACTERISTICS

WINGRIP BITUMINOSO is a very low environmental impact product and it's ready to use.

It has been specifically formulated as bonding agent and for the creation of the waterproofing layer for the setting of ceramics tiles on balconies, showers, bathrooms and swimming pools.

It's easy to apply either on horizontal or vertical surfaces and suitable for overlaying on existing tiles or concrete blocks. It creates an elastic and very hard layer assuring a high adhesion to the cement adhesive. Thanks to its special formulation, WINGRIP BITUMINOSO, doesn't need any kind of reinforcement nor particular adhesives. It is enough using a suitable adhesive.

In case adhesives from WINKLER range should be used, such products are fully covered by the specific insurance policy issued by REALE MUTUA ASSICURAZIONI.

JOCKOL	C1 T (UNI EN 12004)
ROYAL	C2 (UNI EN 12004)
ROYAL SUPER	C2T (UNI EN 12004)
ROYAL SUPER SP	C2T (UNI EN 12004)

ROYAL FAST	C2FT (UNI EN 12004)
ROYAL EXTRA	C2TE (UNI EN 12004)
ROYAL FLEX	C2TES1 (UNI EN 12004)

WINGRIP BITUMINOSO is of fast curing and can be covered after 7 hours after the first application, in suitable weather conditions.

SURFACE PREPARATION

Accurately clean the support to eliminate: dust, crumbly parts, foreign or bondingproof matters. The application must be done on dry surface. Check eventual humidity of the sub-grade, in order to avoid onset of bubbles due to vapour pressure.

The best procedure is the application of a polyethylene sheet sealed by means of bonding tape on the side of the surface exposed to the sun and to check after 24 hours the possible water condensation. In the case of no water condensation, proceed laying of WINGRIP BITUMINOSO, otherwise wait for full drying.

ADVICES

Do not add ANY additive.

Do not use the product if the packaging is damaged.

Do not add water.

APPLICATION

Mix the product before use, to homogenise it. The product is ready to use and can be applied by roller, paintbrush, airless gun. Apply WINGRIP BITUMINOSO in one coat and without using any primer. To ensure waterproofing, apply WINGRIP BITUMINOUS in a continuous and uniform layer, visible from the intense black color.

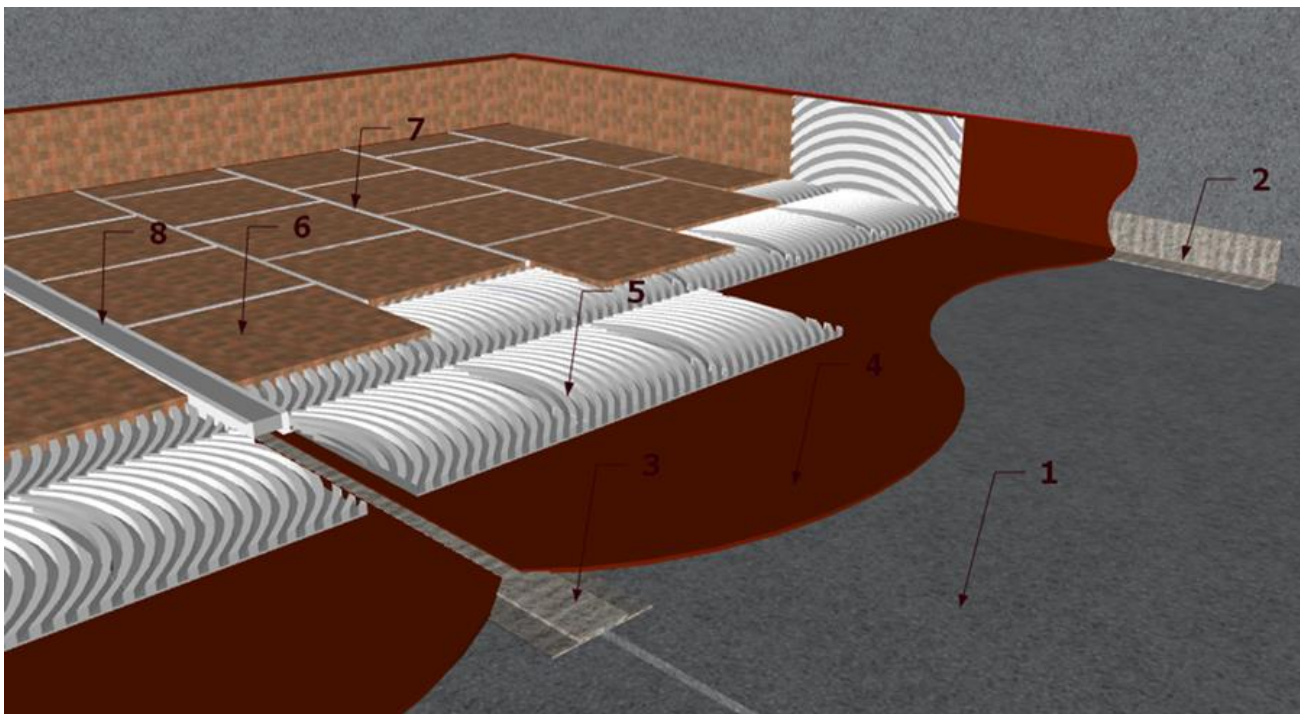

KEY:

1. Concrete substrate
2. **BC SEAL BAND**, self-adhesive band for waterproofing perimeter angles
3. **WINJOINT BAND**, joint cover, waterproofing band
4. **WINGRIP BITUMINOSO**
5. **ROYAL FLEX, C2 TE S1** Adhesive
6. New floor
7. **WINSTUCCO FLEX**, waterproofing, flexible plaster.
8. Pre-shaped structure.

For corners reinforcement and sealing, it's advisable applying **BC SEAL BAND**, self-adhesive band covered with non-woven. For waterproofing and sealing around roof penetrations such as drain, ventilation pipes, other roof penetrations or around plumbing pipes and drains, use **BC SEAL PAD**, self-adhesive butyl square pad, together with **BC SEAL BAND**.

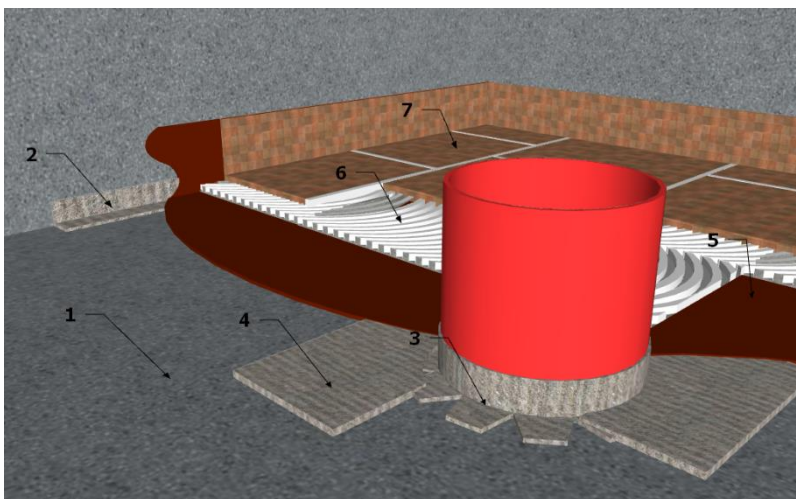

KEY:

1. Structural support
2. **BC SEAL BAND**, Self-adhesive band for sealing corners;
3. Collar shaped **BC SEAL BAND**, to seal the drain.
4. **BC SEAL PAD**, self-adhesive square pad;
5. **WINGRIP BITUMINOSO**;
6. **ROYAL FLEX**, C2 TE S1 adhesive
7. New flooring.

SURFACES WITH JOINTS

Seal the joints **up to 1cm** wide, with the joint cover strip **WINJOINT BAND** (waterproof elastic band, made of rubber and polyester fabric, suitable for waterproofing joints) as described below:

After creating the new joints or restoring the existing ones, apply **WINGRIP BITUMINOSO**, laterally to the joint and for a width that is larger than the joint cover. While the product is still wet, lay the joint cover and stick the perforated side band to the area already treated with **WINGRIP BITUMINOSO**. Once dried, completely cover it with the second coat of **WINGRIP BITUMINOSO**.

Sealing of joints up to 1cm wide

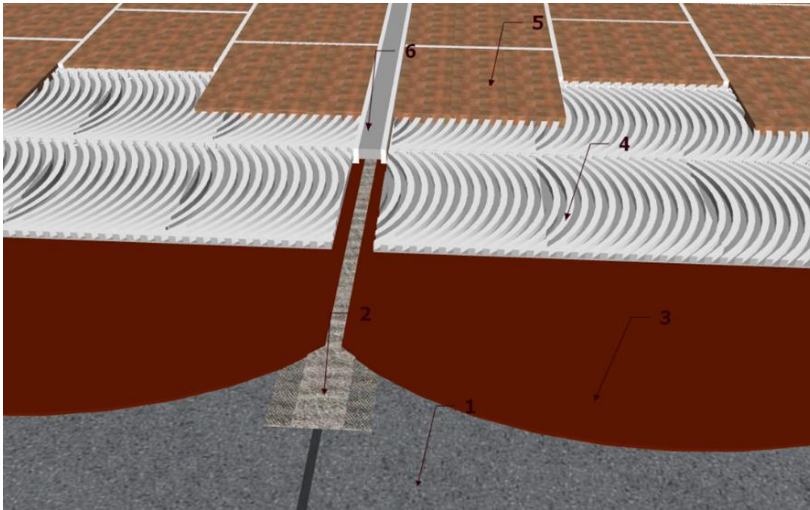

KEYS:

1. Concrete substrate
2. **WINJOINT BAND**, joint cover strip
3. **WINGRIP BITUMINOSO**
4. **ROYAL FLEX**, C2 TE S1 adhesive
5. New flooring
6. Pre-shaped structure.

Use the following system to seal **joints more than 1cm wide**:

WINJOINT FOAM (compressible polyethylene foam backer rod), **WINJOINT SEAL** (polyurethane sealant) and **WINJOINT BAND**, as described below:

After creating the new joints or restoring the existing ones, enter **WINJOINT FOAM** inside the joint to the desired depth and then extrude **WINJOINT SEAL** for the entire length of the joint. Once the sealant has dried, apply **WINJOINT BAND** as previously described.

Sealing of joints more than 1cm wide

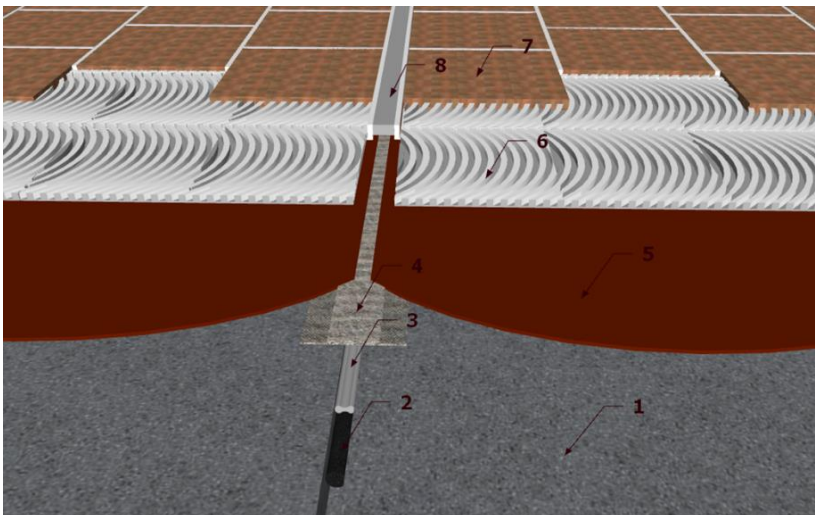

KEYS:

1. Concrete Substrate;
2. **WINJOINT FOAM**, compressible polyethylene foam backer rod
3. **WINJOINT SEAL**, polyurethane sealant
4. **WINJOINT BAND**
5. **WINGRIP BITUMINOSO**;
6. **ROYAL FLEX**, C2 TE S1 Adhesive.
7. New flooring
8. Pre-shaped structure.

WARNING

Before the application it is advisable restore any eventual irregularity on the surface and paste any eventual detached tile. The product must be applied in environmental conditions suitable to guarantee its full drying as soon as possible. Therefore do not apply the product on frost surfaces or when subject to night chill

or with rainy weather. Do not apply the product on supports with hidden humidity. Protect the surface during the first 24 hours from water, rain and snow. For vertical applications, it is advisable using covers which do not weigh more than 25 kg/m². Apply the product at temperatures between +5°C and +35°C. High or low storage temperatures may vary the viscosity of the product. To have optimal workability, we recommend storing WINGRIP BITUMINOSO, at least 24 hours before use, at temperatures close to +20°C.

CONSUMPTION IN HORIZONTAL

500 g/m² in overlay on existing floors.
1 kg/m² on cement blocks.

CONSUMPTION IN VERTICAL

400 g/m² in overlay on existing coverings.
800 g/m² on different kind of walls.

PACKAGING

5 – 10 - 20 kg buckets.

STORAGE

The product in its original and undamaged packaging has a shelf time of 12 months. Please store it at temperatures between +5°C and +35 °C.

SAFETY INSTRUCTIONS

PRECAUTIONS

For information about safety, user must refer to the most recent Safety Data Sheet, edited in accordance with the regulations in force, which contains physical, toxic and other data about the product in use.

ECOLOGY

Do not dispose the product and/or empty containers in the environment. Consult the most recent Safety Data Sheet for further information about disposals.

TECHNICAL FEATURES (average values) PRODUCT FOR PROFESSIONAL USE ONLY

Appearance:	liquid - cream
Colour:	beown if wet / black once dried
BROOKFIELD VISCOSITY at 20°C (cPs)	2500
Specific Weight at 20°C (g/cm ³)	1.15
pH:	10
Solid content:	60%

Tensile Strength at break (ASTM D 2370) (N/mm ²)	0.26
Elongation (ASTM D 2370)	87 %
Water Absorption (ASTM D 471) after 7 days immersion	11%
PERFORMANCES OF PRODUCT IN USE ACCORDING TO EN 14891	
Notified Lab for N. 0407 test report 323166/9011/CPR	
Crack-bridging (+23°C)	1.96 mm
Crack-bridging (+5°C)	1.82 mm
Water permeability	No permeability
Tensile adhesion strength (N/mm²) Initial (after 28 days):	
Adhesion to concrete support	≥ 0.85
Adhesion to the support on tile	≥ 1.00
Tensile adhesion strength (N/mm²) after water immersion (after 28 days):	
Adhesion to concrete support	≥ 1.30
Adhesion to the support on tile	≥ 1.05
Tensile adhesion strength (N/mm²) after frost-defrost cycles (after 28 days):	
Adhesion to concrete support	≥ 0.85
Adhesion to the support on tile	≥ 0.70
Adhesion to the support (N/mm²) after thermal shock after 28 days	
Adhesion to concrete support	≥ 0.80
Adhesion to the support on tile	≥ 0.72
Adhesion to the support (N/mm²) after contact with calcium hydroxide after 28 days	
Adhesion to concrete support	≥ 0.86
Adhesion to the support on tile	≥ 0.76

Volatile Organic Compounds Emission

Parameter	Max. allowed concentration (µ/m ³)
TVOC after 3 days	≤ 750
TVOC after 28 days	≤ 60

Test performed by the EUROFINS institute according to EN 16516, ISO 16000-3-6-9-11 and ASTM D5116-10, Test report n. 392-2017-00404101_G_EN_2

The information contained in this technical data sheet is to the best of our knowledge correct. However, by no means can it be considered a guarantee, as usage, working area and application of the product in accordance with the instructions given and their success in application is beyond our control and is dependent on a number of factors. We decline any responsibility for the improper use of the product as the application recommendations contained herein are to be considered as a general guideline. If at all in doubt, preliminary tests should be carried out. WINKLER S.r.l. reserves the right to modify and up-date said data sheets without prior notice. Clients are kindly requested to verify that they are in possession of the current edition.