

DESCRIPTION OF THE PRODUCT

Developed by WINKLER Research and Development Laboratories WINPOX CEMENT TIXO is a three-component, low thickness, tixotropic, epoxy, cementitious covering, specially designed to make an abrasion resistant and waterproofing both to positive and counter-pressure layer over interior or exterior cementitious surfaces.

USE FIELDS

WINPOX CEMENTO TIXO is indicated for the preparation of surfaces where the subsequent treatment of products even very sensitive to dampness is required.

WINPOX CEMENT TIXO has an excellent waterproofing feature, shown even in case of positive and negative hydrostatic pressure.

WINPOX CEMENT TIXO is applied in buried rooms, lift shafts, new cement structures, plaster coatings, tile coverings and floors. Can be used as a waterproofing finishing smoothing layer, before laying cementitious tiles and / or self-leveling products. As a waterproofing coating of walls and floors for swimming pools, elevator shafts, terraces, balconies, concrete tanks suitable for containing non-drinking water. As vapour barrier both vertically and horizontally. It can be covered by every liquid membrane of WINKLER range, by WFZ5 WINFLEX-CEMENT and WINFLEX-CEMENT SUPER, by cement adhesives of ROYAL SUPER SP line, by BOND CEMENT waterproofing adhesive, with ROYAL FAST for quick bonding and by WINGRIP BITUMINOSO waterproofer for balconies, terraces and bathrooms. If use with UNIBAR FORMULA and WINPAINT polyurethane finishing resin, it makes an exceptional resistant cycle for the finishing of industrial and civil floors, both indoors and outdoors, also subject to vehicular traffic.

SURFACE PREPARATION

The support on which WINPOX CEMENT TIXO is applied must be suitable, it must have a tensile strength of at least 1.5 MPa and must undergo an appropriate preparation, removing any dust, friable parts, oils and foreign substances. Repair any irregularity up to 1.5 mm by using WINPOX CEMENT TIXO itself. To ensure continuity in the corners, use WINPOX CEMENT TIXO to create coves.

PREPARATION OF PRODUCT

Mix well component B to make it homogeneous, then put it together with component A in a clean bucket. Mix thoroughly (with a low-speed drill) avoiding incorporating air bubbles, until getting a homogeneous mixture. Then slowly add component C (Mix of selected binders and aggregates), continuing to mix, until a

lump-free mixture is obtained. Before applying the product, make the mixture resting about 2-3 minutes.

APPLICATION

Wet substrate, apply with a trowel with thicknesses from 1 to 2 mm per coat, depending on the substrate. Wait at least 24 hours after the first coat application, before applying other layers. Over 48 hours wait, sanding the surface will be needed before applying other layers. Apply at temperatures between +5°C and +35°C

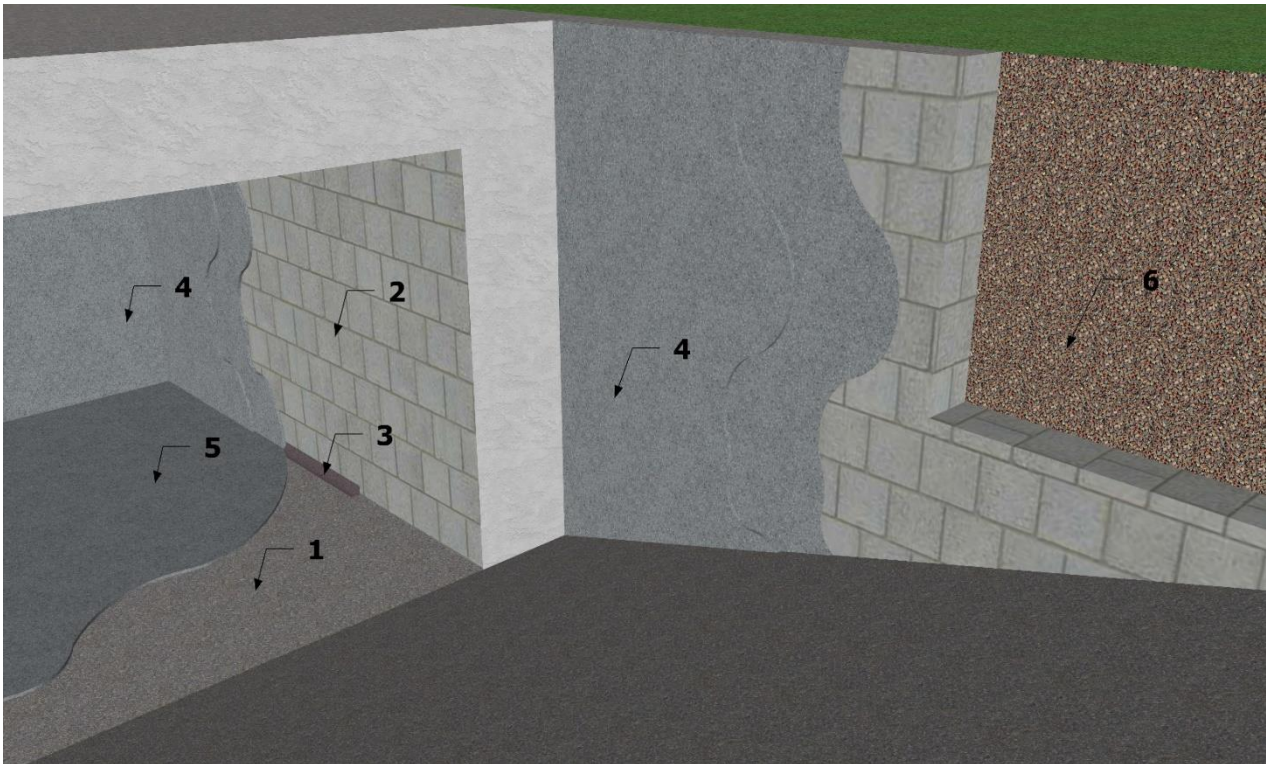

KEYS:

1. Concrete substrate with rising damp;
2. Retaining wall;
3. Cove made using WINPOX CEMENT TIXO;
4. Retaining walls waterproofing with WINPOX CEMENT TIXO in two coats;
5. Floor waterproofing with WINPOX CEMENT SL;
6. Backfill.

WARNINGS

The product must cure perfectly. It is therefore recommended to check that at the time of application, and at least in the following 24 hours, no rising damp occurs. Before over application with other products, check that it is completely dry.

RECOMMENDATIONS

Do not use if the container is damaged

Do not add water and or solvents
Sand before applying other products.

CYCLES

FLOORS SUBJECT TO VEHICULAR TRAFFIC:

WINPOX CEMENT TIXO, vapor barrier layer

UNIBAR FORMULA, primer

WINPAINT, non-yellowish colored finishing layer

CONSUMPTION:

WINPOX CEMENT TIXO: 4.5kg/m² in two coats

UNIBAR FORMULA: 150 g/m²

WINPAINT: 250 g/m² (in two coats)

SWIMMING POOL WITH RESIN FINISHING LAYER.

WINPOX CEMENT TIXO

WINFLOOR FIX 44, primer

WINPAINT P non-yellowish colored finishing layer

CONSUMPTION:

WINPOX CEMENT TIXO: 4.5 kg/m² in two coats as vapor barrier layer
2.5 kg/m² in one coat as shaving layer

WINFLOOR FIX 44: 150 g/m²

WINPAINT P: 250 g/m² (in two coats)

SWIMMING POOL WITH TILED FINISHING LAYER.

WINPOX CEMENT TIXO

BOND CEMENT and/or ROYAL SUPER SP and/or ROYAL FAST (fast-setting tile adhesive)

WINSTUCCO EPOX.

CONSUMPTION:

WINPOX CEMENT TIXO: 4.5 kg/m² in two coats as vapor barrier layer
2.5 kg/m² in one coat as shaving layer

BOND CEMENT and/or

ROYAL SUPER SP and/or

ROYAL FAST (fast setting tile adhesive): 3.5 kg/m²

WINSTUCCO EPOX: 0.5 kg/m²

CONSUMPTION:

2.2 kg/ m² for mm of thickness.

PACKAGING

15.4 kg per container containing:

Component A 0.90 kg

Component B 2.50 kg

Component C 12.0 Kg

Individual packs for a total of 30.80 Kg composed by:

Component A 1.80 kg

Component B 5.00 kg

Component C 24.00 Kg

STORAGE

WINPOX CEMENT TIXO has a shelf life of one year when stored in original sealed packaging in a cool, dry place. When stored at lower temperature limit, the resins have the tendency of crystallization. This effect can vanish without influencing the quality, by slight swirling movement of the individual components, heating them in a bain-marie up to a maximum of +50°C.

PRECAUTIONS

SAFETY RULES

For information on safety standards, the user must refer to the most recent Safety Data Sheet, drawn up in accordance with the regulations in force, containing the physical, toxicological, and other data relating to the product in use.

ECOLOGY

Do not dispose of the product and/or empty containers in the environment. Consult the most recent Safety Data Sheet for further information on possible disposal.

TECHNICAL AND APPLICATION DATA

Colour of compound	Grey
Bulk mass at 23°C (g/cm ³)	2.20
Pot-life (min) at 20°C	30 ± 5
Over-painting time	From 24 h to 7days
Resistance to compression after 28 days (N/mm ²) EN 12190	60 ± 5
Resistance to flexion after 28 days (N/mm ²) EN 196/1	15 ± 5
Resistance to negative pressure UNI EN 12390-8 (on concrete A/C.0,6)	7 bar

PRODUCT PERFORMANCES ACCORDI TO UNI EN 1504-2

Permeability to water vapor (UNI EN 7783)	S _D > 50 m (CLASS III)
Capillary absorption and water permeability (UNI EN 1062-3)	W < 0.0425
Adhesion strength by direct traction (UNI EN 1542)	≥ 5 N/mm ²
Adhesion strength after 50 freeze-thaw cycles with de-icing salts (EN 13687/1)	≥ 4 N/mm ²
Fire reaction EN 13501-1	A2-s1,d0

EMISSION OF VOLATILE ORGANIC COMPOUNDS

Parameter	Max. allowed concentration (μm^3)
TVOC after 3 days	≤ 750
TVOC after 28 days	≤ 60

Test performed by the EUROFINS institute according to EN 16516, ISO 16000-3-6-9-11 and ASTM D5116-10, test report N. 392-2018-000081401_G_EN_02

The information contained in this technical data sheet is to the best of our knowledge correct. However, by no means can it be considered a guarantee, as usage, working area and application of the product in accordance with the instructions given and their success in application is beyond our control and is dependent on a number of factors. We decline any responsibility for the improper use of the product as the application recommendations contained herein are to be considered as a general guideline. If at all in doubt, preliminary tests should be carried out. WINKLER S.r.l. reserves the right to modify and up-date said data sheets without prior notice. Clients are kindly requested to verify that they are in possession of the current edition.